

# DS,DP,DA SERIES

## DIMENSIONS

### DS(R)

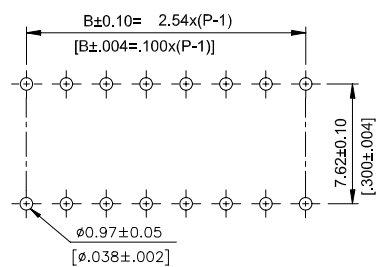
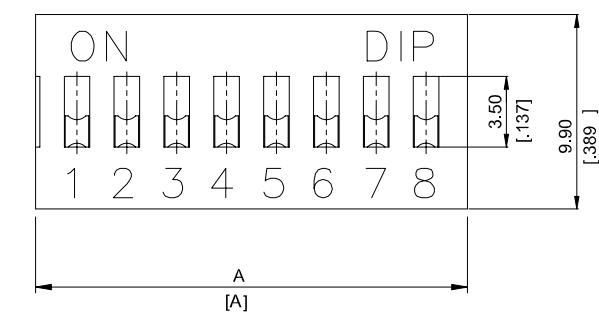

P.C.B. LAYOUT

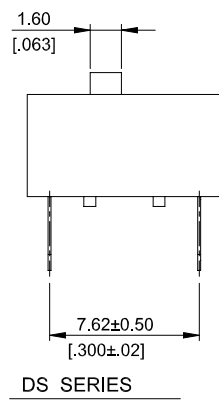
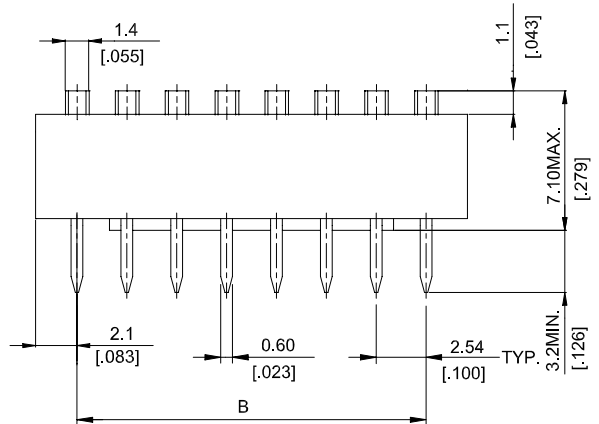

DS SERIES

DS -12 DSR-12	12	31.84[1.254]	27.94[1.100]
DS -10 DSR-10	10	26.76[1.054]	22.86[0.900]
DS -09 DSR-09	9	24.22[0.954]	20.32[0.800]
DS -08 DSR-08	8	21.68[0.854]	17.78[0.700]
DS -07 DSR-07	7	19.14[0.754]	15.24[0.600]
DS -06 DSR-06	6	16.60[0.654]	12.70[0.500]
DS -05 DSR-05	5	14.06[0.554]	10.16[0.400]
DS -04 DSR-04	4	11.52[0.454]	7.62[0.300]
DS -03 DSR-03	3	8.98[0.354]	5.08[0.200]
DS -02 DSR-02	2	6.44[0.254]	2.54[0.100]
PROD. NO.	NO. OF POS.	DIM. A	DIM. B

SCHEMATIC(TYP.)

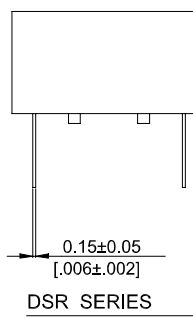
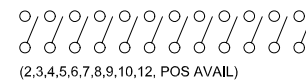

DSR SERIES

### DA

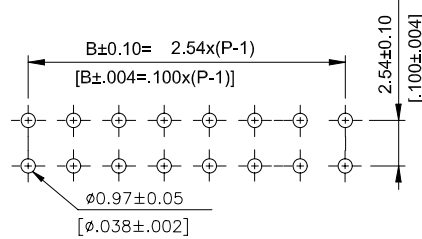
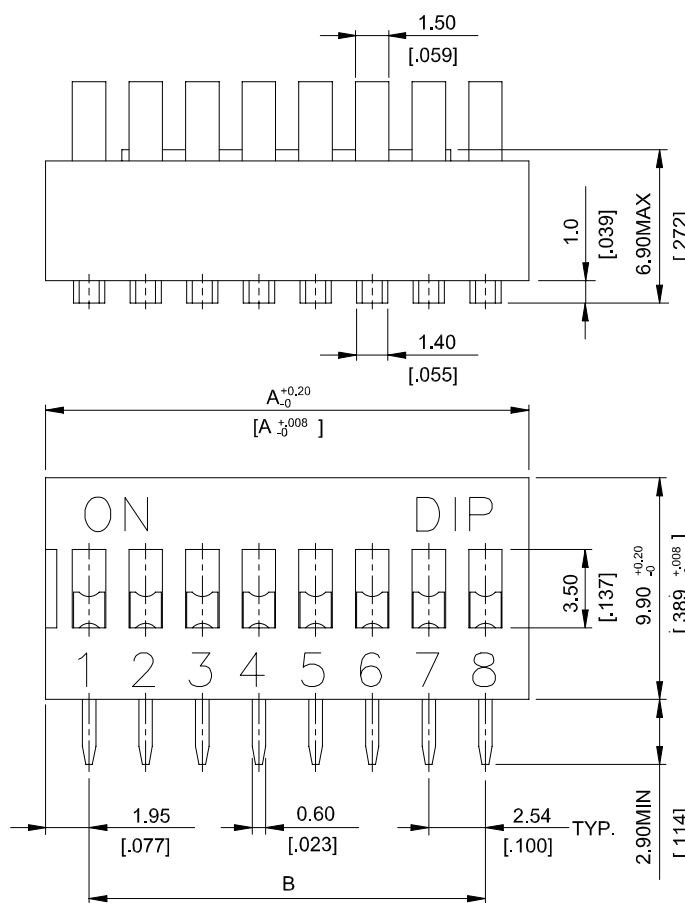

P.C.B. LAYOUT

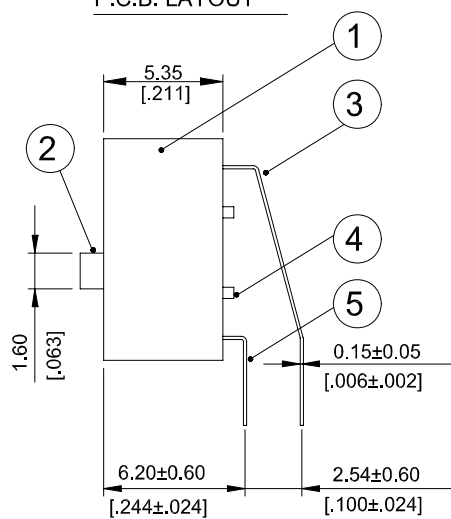
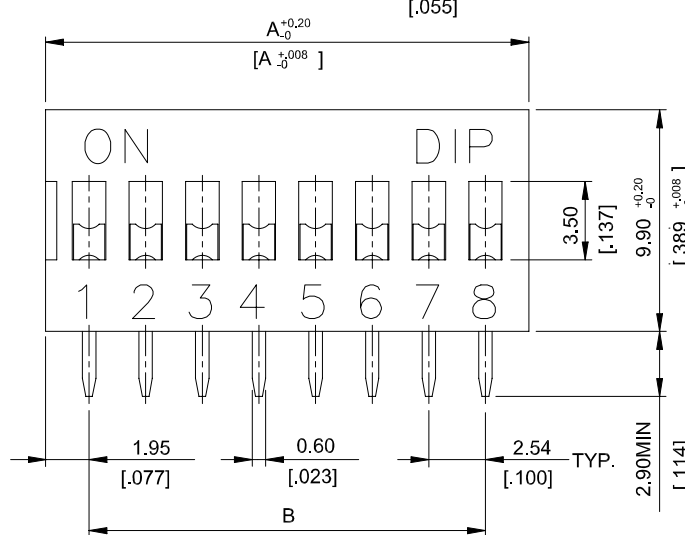

DA-12	12	31.84[1.254]	27.94[1.100]
DA-10	10	26.76[1.054]	22.86[0.900]
DA-09	9	24.22[0.954]	20.32[0.800]
DA-08	8	21.68[0.854]	17.78[0.700]
DA-07	7	19.14[0.754]	15.24[0.600]
DA-06	6	16.60[0.654]	12.70[0.500]
DA-05	5	14.06[0.554]	10.16[0.400]
DA-04	4	11.52[0.454]	7.62[0.300]
DA-03	3	8.98[0.354]	5.08[0.200]
DA-02	2	6.44[0.254]	2.54[0.100]
PROD. NO.	NO. OF POS.	DIM. A	DIM. B

SCHEMATIC(TYP.)

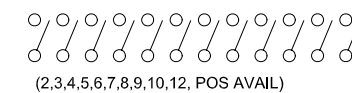

# DP(L)

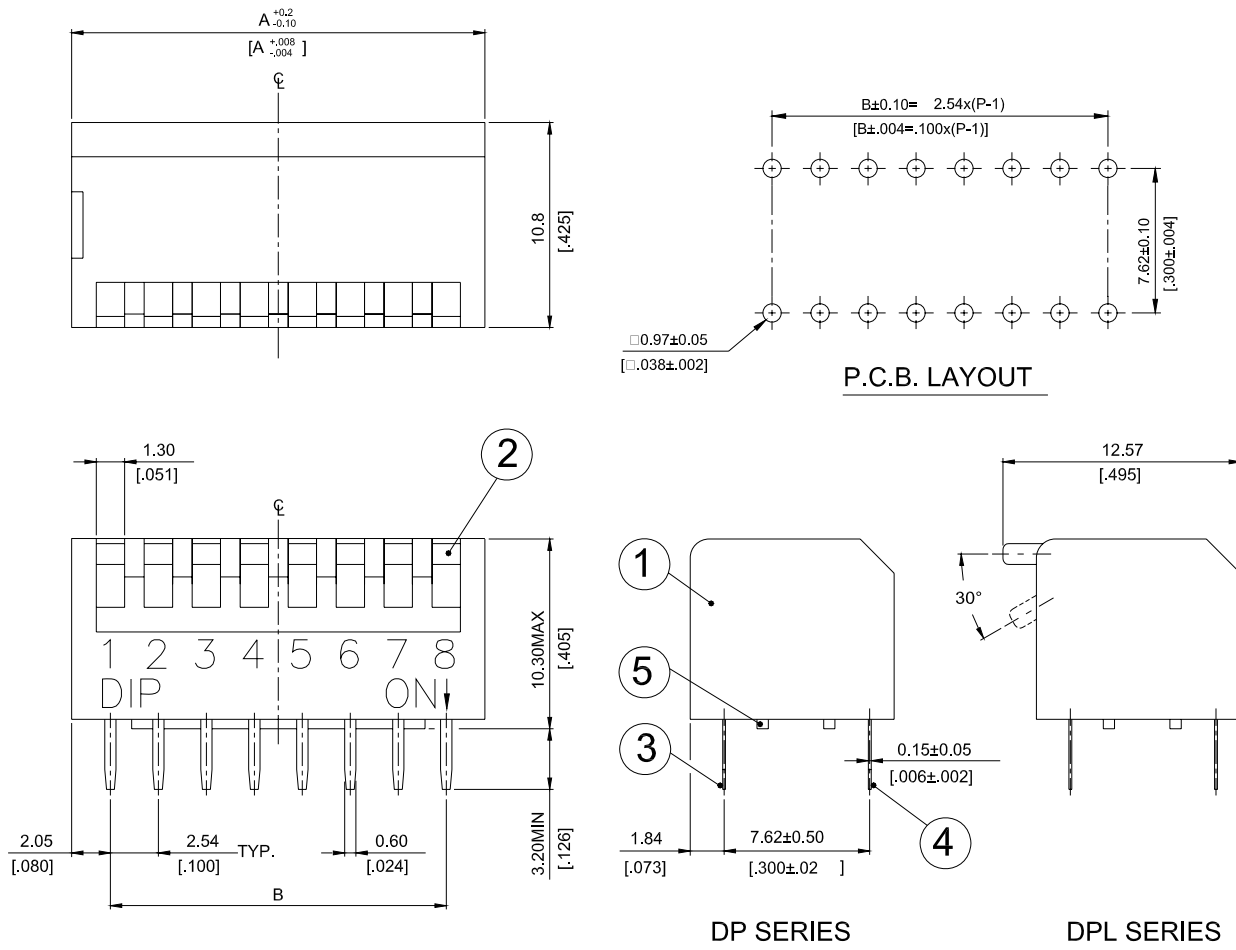

DP -12 DPL-12	12	32.04[1.261]	27.94[1.100]
DP -10 DPL-10	10	26.96[1.061]	22.86[.900]
DP -09 DPL-09	9	24.42[.961]	20.32[.800]
DP -08 DPL-08	8	21.88[.861]	17.78[.700]
DP -07 DPL-07	7	19.34[.761]	15.24[.600]
DP -06 DPL-06	6	16.80[.661]	12.70[.500]
DP -05 DPL-05	5	14.26[.561]	10.16[.400]
DP -04 DPL-04	4	11.72[.461]	7.62[.300]
DP -03 DPL-03	3	9.18[.361]	5.08[.200]
DP -02 DPL-02	2	6.64[.261]	2.54[.100]
PROD. NO.	NO. OF POS.	DIM. A	DIM. B

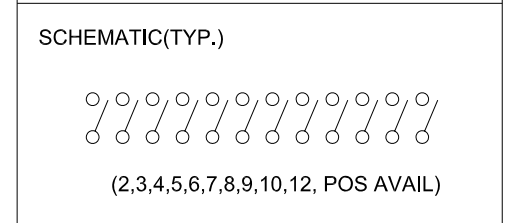

# HOW TO ORDER



**Package Style:**  
 = Tube

**Soldering:**  
**V** = Lead Free Solderable

**Seal:**  
 = Regular  
**T** = Top Tape Sealed

**▲ On/Off Position**  
 = Push Down On  
**U** = Push Down Off  
**<▲ U Only For DP(L) >**

**Color Of Cover**  
 = Red  
**▲B** = Blue  
**▲K** = Black  
**<▲ Subject to our final confirmation >**

**Number Of Positions:**  
**02** = 2 Positions      **07** = 7 Positions  
**03** = 3 Positions      **08** = 8 Positions  
**04** = 4 Positions      **09** = 9 Positions  
**05** = 5 Positions      **10** = 10 Positions  
**06** = 6 Positions      **12** = 12 Positions

**DS**     = Raised Actuator  
           = Recessed Actuator

**DA**     = Raised Actuator

**DP**     = Short Key  
           = Long Key

**DS** = Slide Type Dip Switch  
**DA** = Right Angle Type Dip Switch  
**DP** = Piano Type Dip Switch

## **SPECIFICATION**

### **△MECHANICAL**

Mechanical Life: 2,000 operations per switch.  
Operation Force: 400gf max. (DP Series)  
1,000gf max. (DS & DA Series)  
Stroke: 2.0mm  
Operation Temperature: -20°C to +70°C  
Storage Temperature: -40°C to +85°C

### **△ELECTRICAL**

Electrical Life: 2,000 operations per switch 24VDC,25mA  
Non-Switching Rating: 100mA , 50VDC  
Switching Rating: 25mA , 24VDC  
Contact Resistance: 50mΩ max. at initial  
Insulation Resistance:{at 500 VDC} 100MΩ min.  
Dielectric Strength: 500VAC / 1 minute  
Circuit: SPST

## **MATERIALS**

△BASE: UL94V-0 PBT Thermoplastic  
Color: Black  
△COVER UL94V-0 PBT Thermoplastic  
Color: Red, Black, Blue  
△ACTUATOR: UL94V-0 PBT High Thermoplastic  
Color: White  
△CONTACT: Phosphor bronze with gold plating over nickel  
△TOP SEAL: Polyester Film  
△POTTING MATERIAL: Epoxy

## **SOLDERING PROCESS**

△Keep all switch contacts in their “OFF” position for all operations.

△WAVE SOLDERING: Recommended temperature at 500°F (260°C) max. 5 seconds for through hole type.

△HAND SOLDERING: Use a soldering iron of 30 watts, controlled at 350°C approximately max 5 seconds.

△Make sure switch is in “OFF” position during soldering process, or it will decrease the operating force and meanwhile increase the contact resistance.

△Do not wash the switch body except top tape sealed type, which suitable for spray cleaning method from top of the s/w.

## **PACKING**

Part Number	Number Per Tube	Part Number	Number Per Tube
DS(R)-02	72	DS(R)-02-T	70
DS(R)-03	51	DS(R)-03-T	50
DS(R)-04	40	DS(R)-04-T	39
DS(R)-05	32	DS(R)-05-T	32
DS(R)-06	27	DS(R)-06-T	28
DS(R)-07	24	DS(R)-07-T	24
DS(R)-08	21	DS(R)-08-T	21
DS(R)-09	19	DS(R)-09-T	19
DS(R)-10	17	DS(R)-10-T	17
DS(R)-12	14	DS(R)-12-T	14
DP(L)-02	70	DP(L)-02/T	65
DP(L)-03	50	DP(L)-03-T	49
DP(L)-04	39	DP(L)-04-T	39
DP(L)-05	32	DP(L)-05-T	32
DP(L)-06	27	DP(L)-06-T	27
DP(L)-07	24	DP(L)-07-T	24
DP(L)-08	21	DP(L)-08-T	21
DP(L)-09	19	DP(L)-09-T	19
DP(L)-10	17	DP(L)-10-T	17
DP(L)-12	14	DP(L)-12-T	14
DA-02	73	DA-02-T	70
DA-03	52	DA-03-T	50
DA-04	40	DA-04-T	39
DA-05	33	DA-05-T	32
DA-06	28	DA-06-T	28
DA-07	24	DA-07-T	24
DA-08	21	DA-08-T	21
DA-09	19	DA-09-T	19
DA-10	17	DA-10-T	17
DA-12	14	DA-12-T	14

DS(R)

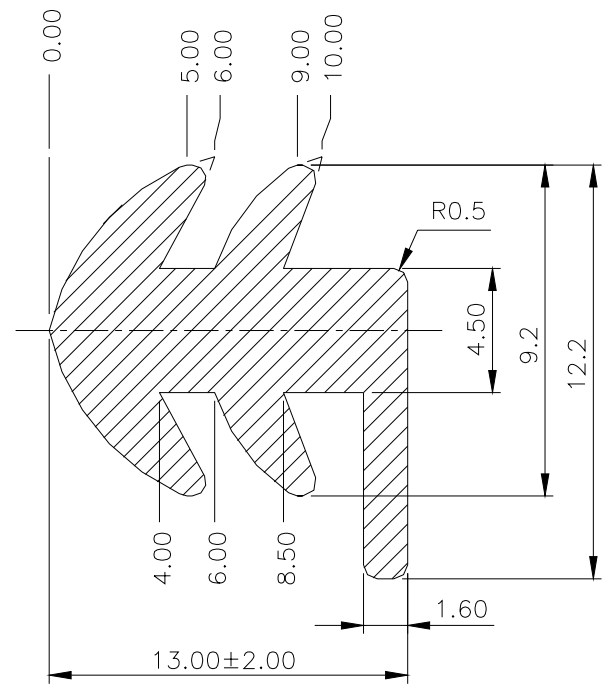
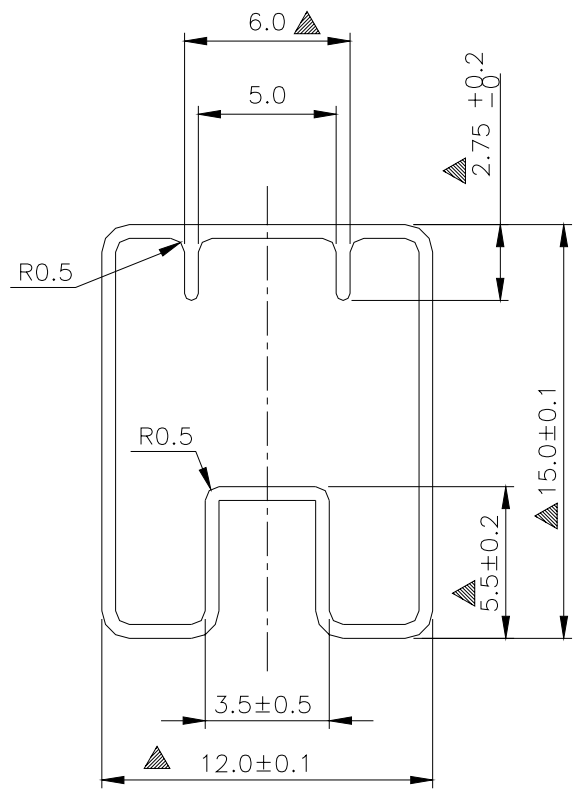

DP(L)

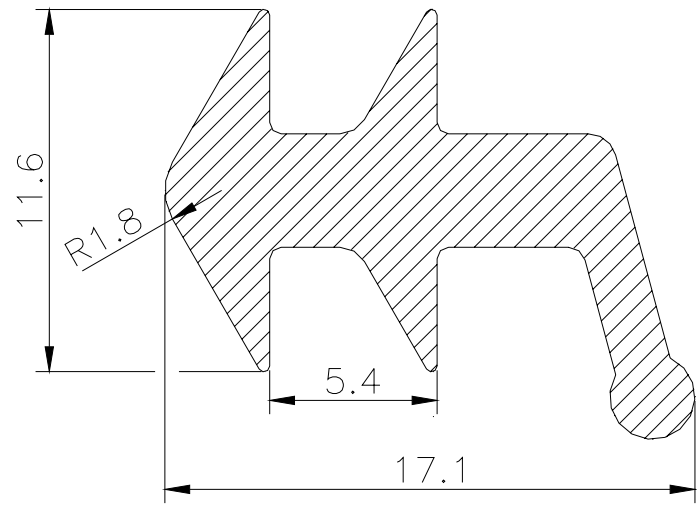
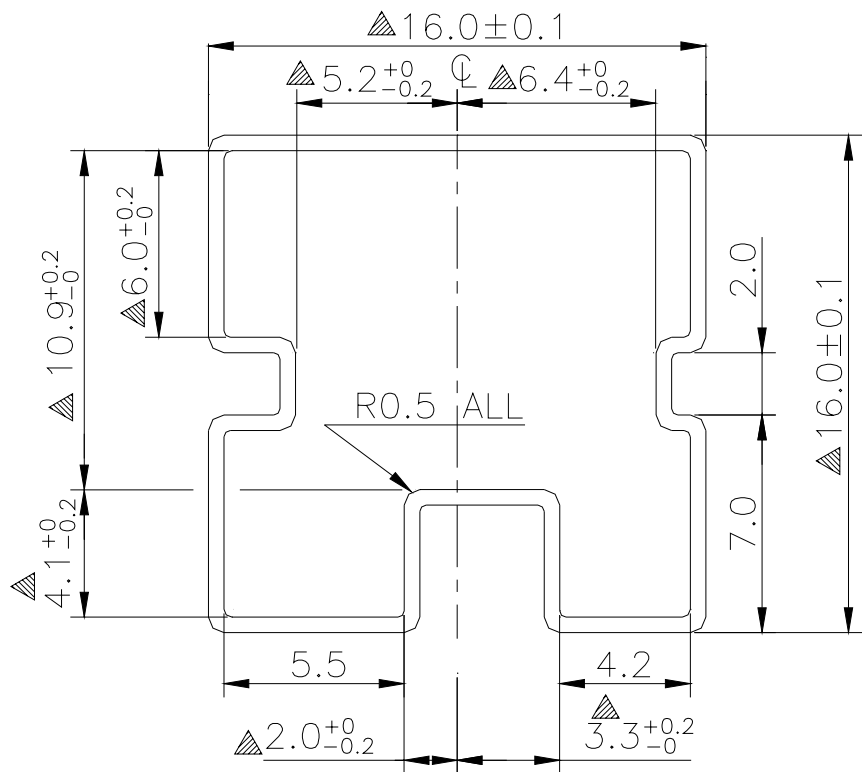

DA

