

SCHMATIC

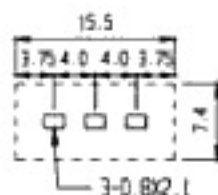

PCB LAYOUT

RoHS Compliance

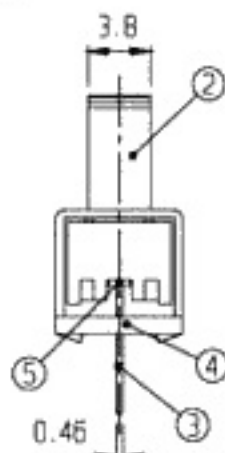
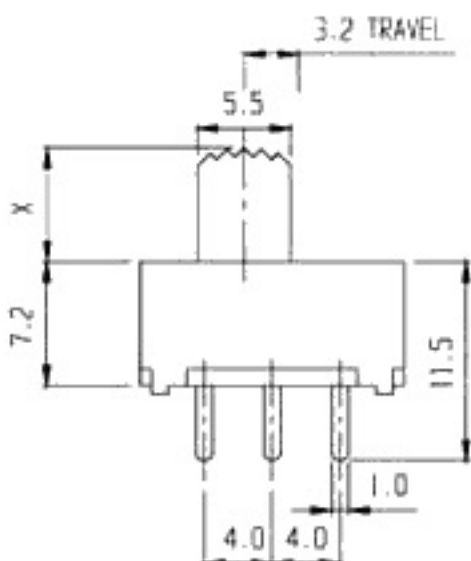

5	CONTACT	B S P	1	Ag PLATED
3	TERMINAL	BRASS	3	Ag PLATED
1	FRAME	SPCC	1	Ni PLATED
NO	PART	MATERIAL	QTY	REMARKS

6	SPRING	STEEL WIRE	1	
4	TERMINAL BASE	PHENOL RESIN	1	NATURAL
2	KNOB	P O M	1	G 1.5-15
NO	PART	MATERIAL	QTY	REMARKS

ISSUED

SPECIFICATION

TITLE: SLIDE SWITCH (1P2T)

RATING: DC 30V 0.3A
CONTACT RESISTANCE: 30mΩ max.
INSULATION RESISTANCE: 500MΩ at 500V DC
WITHSTAND VOLTAGE: AC 500V for 1 minute
OPERATION FORCE: REFER ATTACH SPECIFICATION
SWITCHING LIFE: 10K cycles min.

MODEL NO: SS-12F01 ( G )

TOLERANCE	UNIT: MM	DWN.	hoo
UP TO 1.0:±0.1	SCALE: 2.5:1	CHK'D.	mm
1.0 TO 10.0:±0.2	VERSION: 01	APPD.	
OVER 10.0:±0.3	DRWG NO:		

