

REV.	NOTES	DATE
A	RELEASED	2004/08/08

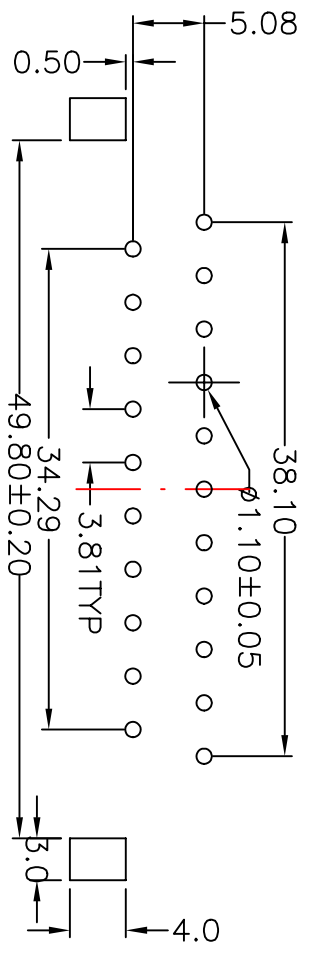
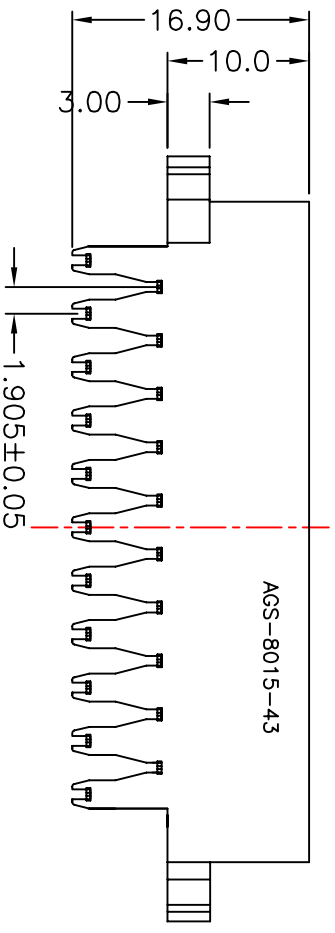
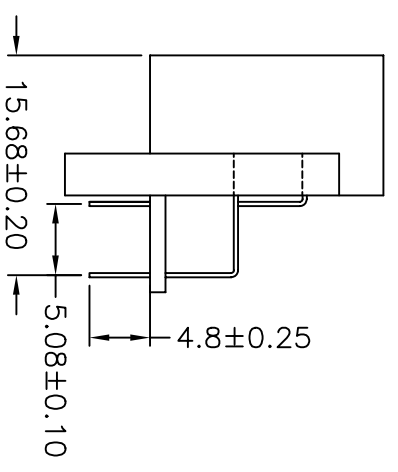
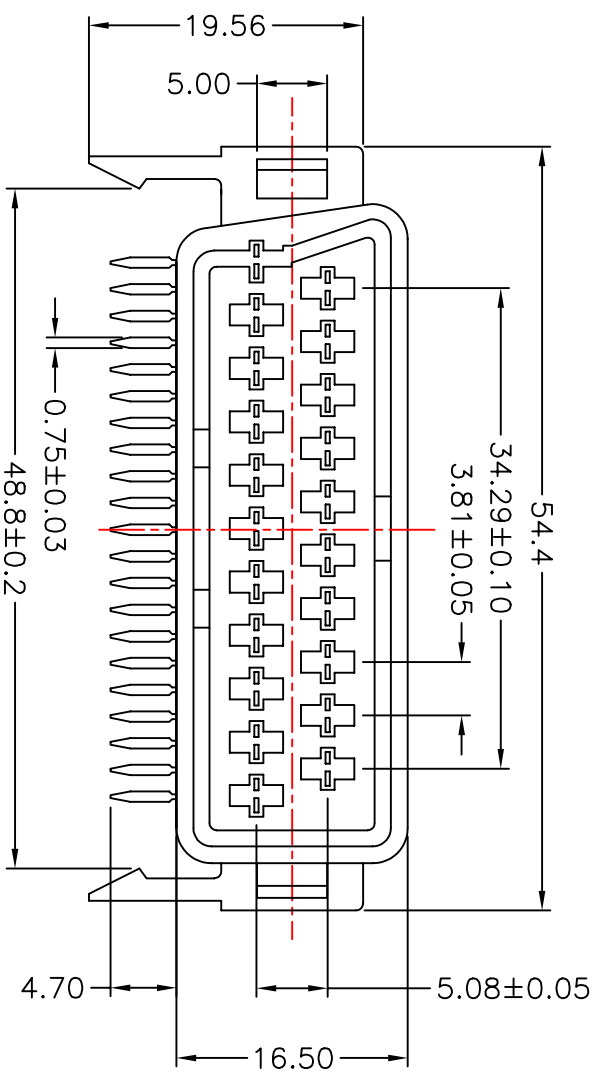

PCB LAYOUT

- NOTES:
- MATERIALS
 - Insulator: Pc
 - Contact: Brass
 - Contact Plating: Tin Plated
 - SPECIFICATIONS
 - Current Rating: 5Amp
 - Dielectric Strength: 1000V AC for one minute
 - Insulator Resistance: 5000MΩ Min.(at 500V DC)
 - Operation Temperature: -55° C to +105° C

DIMENSIONS TOLERANCE		METRIC	
0 = ±.3		0 = ±.3	
.00 = ±.20		.00 = ±.20	
.0000 = ±.XXX		.0000 = ±.XXX	
ANG = ±2°		ANG = ±2°	

單位 (UNITS)	mm	圖名 (NAME)	90度母座有柱有孔端 PC 無毒 (KSD) 專用
數量 (QTY)	N/A	料號 (PART NUMBER)	ASC+0350-40CK
材料 (M'T'L)	SEE NOTE	圖號 (DRAW NUMBER)	RSC035040CK
處理 (FINISH)	SEE NOTE	圖檔 (FILE NAME .DWG)	E:GCT/A/SC/03
繪圖 (DRAW)		比例 (SCALE)	1/1
設計 (DE'N)		圖紙 (SIZ)	A4
審核 (CHK)		頁次 (SHEET)	1
核准 (APP'D)		版本 (REV.)	A