

Part Number: WPES-164AN3BX2 W

U:Sn Cu
Blank:Sn Pb

Notes:

*Material

Body : NYLON66+30%G.F or PBT+30%G.F,
UL 94V-0 Rated.

Color: White or Blank

Contacts : Brass or Phosphor Bronze

Plating: Gold plating over Nickel on contact area; Tin/Lead plating on terminal.

*Mechanical:

Insertion Force: 1.15N max per contact pair;
Withdrawal Force: 0.15N min per contact pair;
Contact Retention Force: 4.9N min per contact;

*Electrical Specification

Contact Resistance : 30 Milliohms Max.

Current Resistance : 1.1 Ampere

Insulation Resistance : 1000 Megohms Min, At 500V AC.

Operating Temperature : -55°C to +105°C

*How to order:

WPES-098 A N 3 B X 2 W

- W: *WINNING* Mark
- U:Sn Cu
- Blank:Sn Pb
- 2:Plastic Posts
- 2:Solder 2.3mm
- 3:Solder 3.0mm
- B:Brass
- 3:Phosphor Bronze
- 1:Black
- N:NYLON66
- B:PBT
- Selective Gold A:Flash
- Number of contacts:164P

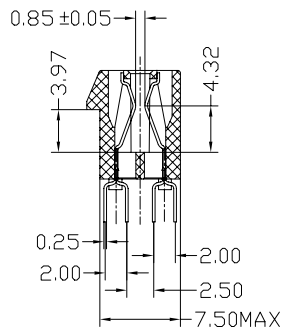
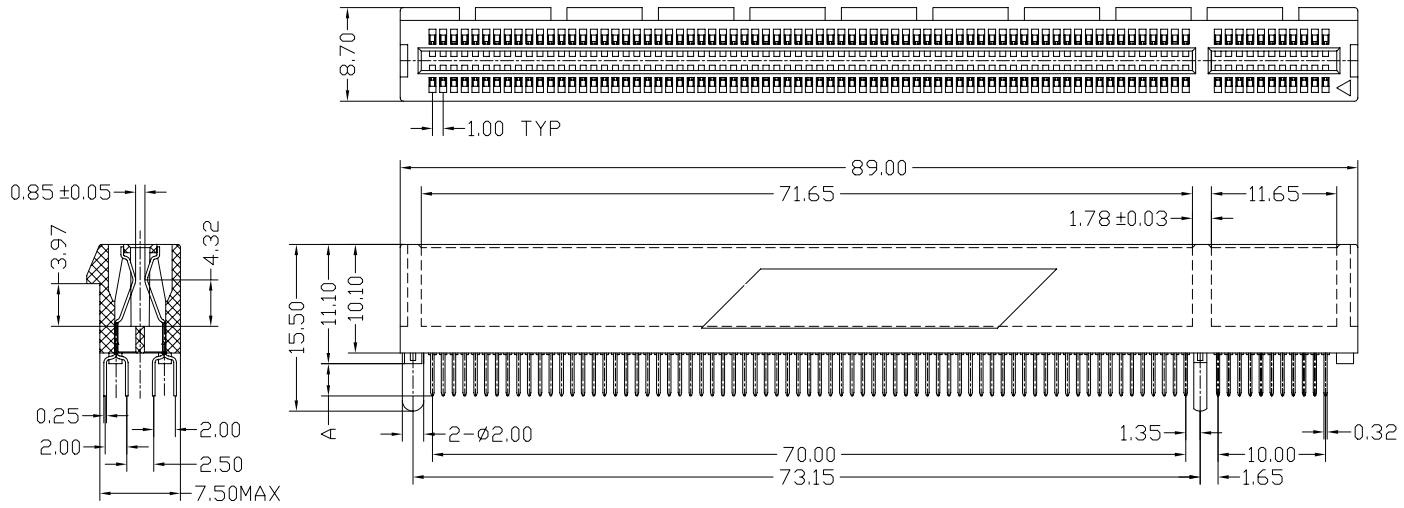

Type	Dim 'A'
Solder2.3	2.30
Solder3.0	3.00

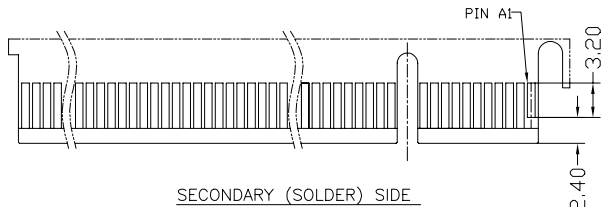
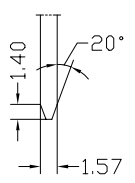
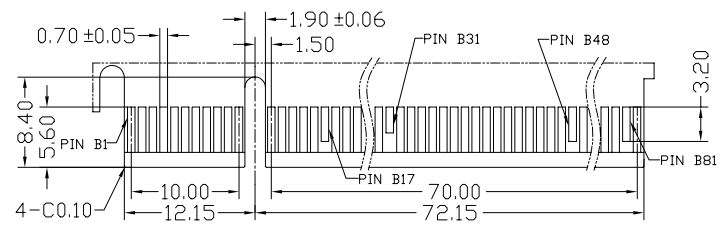
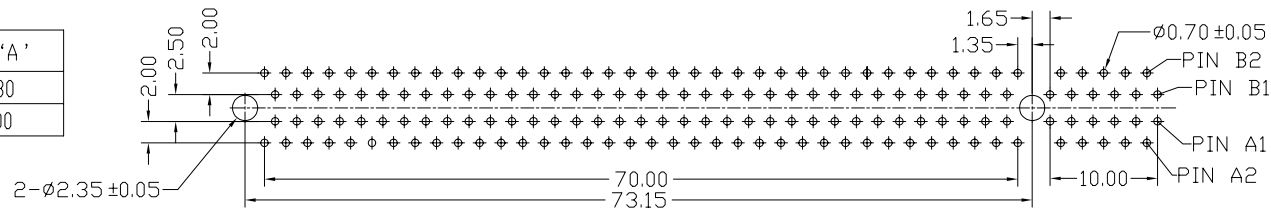

REV	Units	mm	Scale	1.6:1	Drawing By	Data
	Tolerance Unless Otherwise Specified				Reviewed By	Data
	.X	~	±0.38		Approval By	Data
	.XX	~	±0.25			
	.XXX	~	±0.20			
	Angle	~	± 3°			

Date	Sheet	Title	PCI EXPRESS CONNECTOR
	1 of 1	Strip Form Pin 164P Plastic Posts	
Third Angle Projection		Drawing No.	REV
		F/Name	

Part Number: WPES-098AN3BX2 W

U:Sn Cu
Blank:Sn Pb

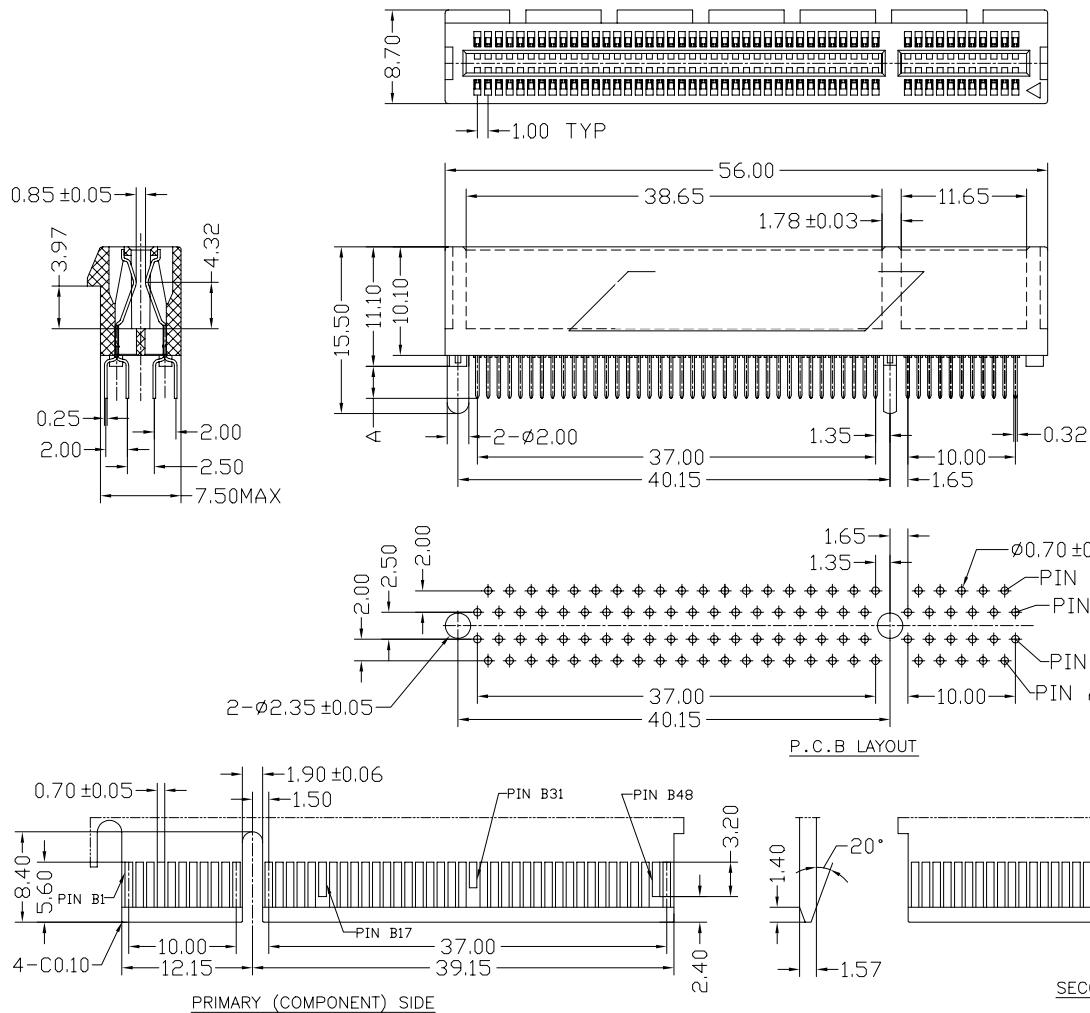

Type	Dim 'A'
Solder2.3	2.30
Solder3.0	3.00

Notes:

*Material

Body : NYLON66+30%G.F or PBT+30%G.F,
UL 94V-0 Rated.

Color: White or Black

Contacts : Brass or Phosphor Bronze

Plating: Gold plating over Nickel on contact area; Tin/Lead plating on terminal.

*Mechanical:

Insertion Force: 1.15N max per contact pair;
Withdrawal Force: 0.15N min per contact pair;
Contact Retention Force: 4.9N min per contact;

*Electrical Specification

Contact Resistance : 30 Milliohms Max.
Current Resistance : 1.1 Ampere
Insulation Resistance : 1000 Megohms Min, At 500V AC.
Operating Temperature : -55°C to +105°C

*How to order:

WPES-098 A N 3 B X 2 W

- W: "WINNING" Mark
- U:Sn Cu
- Blank:Sn Pb
- 2:Plastic Posts
- 2:Solder 2.3mm
- 3:Solder 3.0mm
- B:Brass
- P:Phosphor Bronze
- 3:White
- 1:Black
- N:NYLON66
- B:PBT
- Selective Gold A:Flash
- Number of contacts:98P

REV	Units	mm	Scale	1.6:1	Drawing By	Data
	Tolerance Unless Otherwise Specified				Reviewed By	Data
	.X	~	±	0.38	Approval By	Data
	.XX	~	±	0.25		
	.XXX	~	±	0.20		
	Angle	~	±	3°		

Date	Title	REV
Sheet 1 of 1	PCI EXPRESS CONNECTOR Strip Form Pin 98P Plastic Posts	
Third Angle Projection	Drawing No.	
F/Name		

Part Number: WPES-064AN3BX2 W

U:Sn Cu
Blank:Sn Pb

Notes:

*Material

Body : NYLON66+30%G.F or PBT+30%G.F,
UL 94V-0 Rated.

Color: White or Black

Contacts : Brass or Phosphor Bronze

Plating: Gold plating over Nickel on contact area; Tin/Lead plating on terminal.

*Mechanical:

Insertion Force: 1.15N max per contact pair;
Withdrawal Force: 0.15N min per contact pair;
Contact Retention Force: 4.9N min per contact;

*Electrical Specification

Contact Resistance : 30 Milliohms Max.

Current Resistance : 1.1 Ampere

Insulation Resistance : 1000 Megohms Min, At 500V AC.

Operating Temperature : -55°C to +105°C

*How to order:

WPES-064 A N 3 B X 2 W

W: *WINNING* Mark
U:Sn Cu
Blank:Sn Pb
2:Plastic Posts
2:Solder 2.3mm
3:Solder 3.0mm
B:Brass
P:Phosphor Bronze
3:White
1:Black
N:NYLON66
B:PBT
Selective Gold A:Flash
Number of contacts:64P

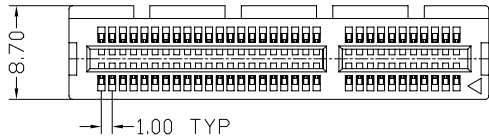

Type	Dim 'A'
Solder2.3	2.30
Solder3.0	3.00

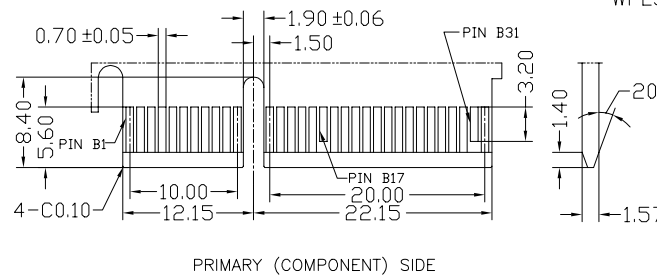
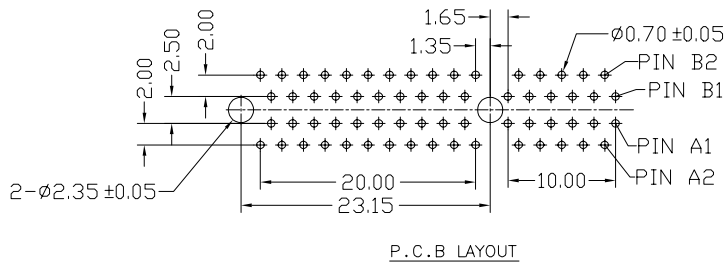
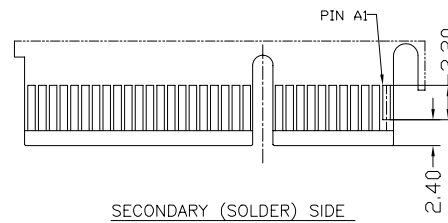
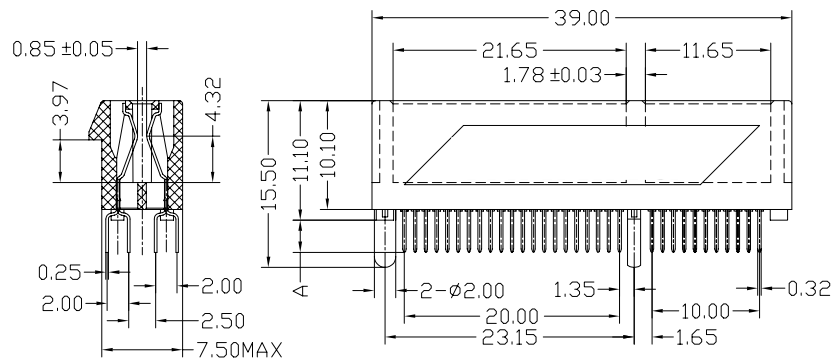

REV	Units	mm	Scale	1.6:1	Drawing By	Data				
	Tolerance Unless Otherwise Specified				Reviewed By	Data	Date	Sheet	Title	PCI EXPRESS CONNECTOR Strip Form Pin 64P Plastic Posts
	.X	~	±0.38		Approval By	Data	1 of 1			
	.XX	~	±0.25				Third Angle Projection	Drawing No.	REV	
	.XXX	~	±0.20				F/Name			
	Angle	~	± 3°							

Part Number: WPES-036AN3BX2 W

U:Sn Cu
Blank:Sn Pb

Notes:

*Material

Body : NYLON66+30%G.F or PBT+30%G.F,
UL 94V-0 Rated.

Color: White or Black

Contacts : Brass or Phosphor Bronze

Plating: Gold plating over Nickel on contact
area; Tin/Lead plating on terminal.

*Mechanical:

Insertion Force: 1.15N max per contact pair;
Withdrawal Force: 0.15N min per contact pair;
Contact Retention Force: 4.9N min per contact;

*Electrical Specification

Contact Resistance : 30 Milliohms Max.

Current Resistance : 1.1 Ampere

Insulation Resistance : 1000 Megohms Min, At 500V AC.

Operating Temperature : -55°C to +105°C

*How to order:

WPES-036 A N 3 B X 2 W

- W: *WINNING* Mark
- U:Sn Cu
- Blank:Sn Pb
- 2:Plastic Posts
- 2:Solder 2.3mm
- 3:Solder 3.0mm
- B:Brass
- P:Phosphor Bronze
- 3:White
- 1:Black
- N:NYLON66
- B:PBT
- Selective Gold A:Flash
- Number of contacts:36P

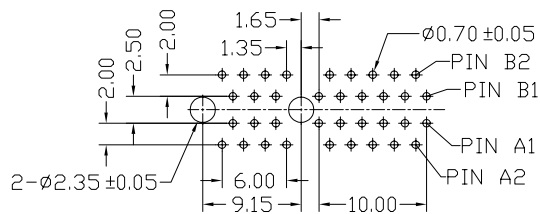
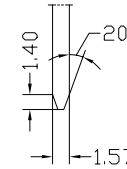
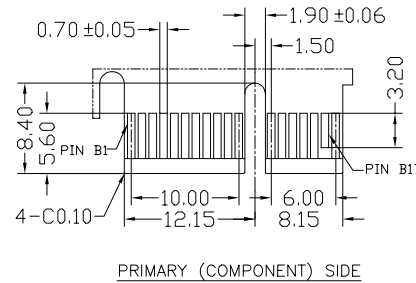
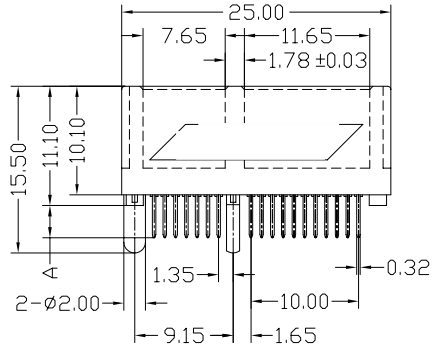
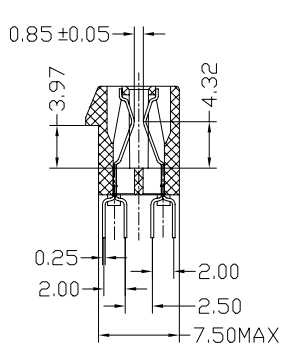
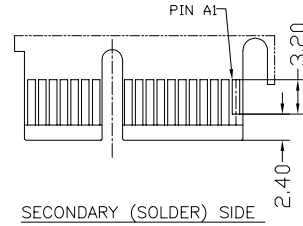
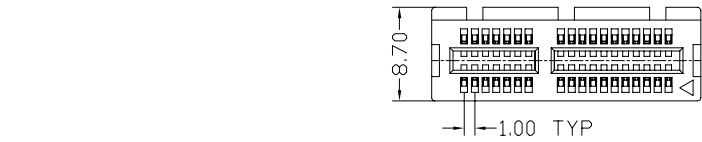

P.C.B. LAYOUT

Type	Dim 'A'
Solder2.3	2.30
Solder3.0	3.00

REV	Units	mm	Scale	16:1	Drawing By	Data				
	Tolerance Unless Otherwise Specified				Reviewed By	Data	Date	Sheet	Title	PCI EXPRESS CONNECTOR Strip Form Pin 36P Plastic Posts
	.X	~	±0.38		Approval By	Data	1 of 1			
	.XX	~	±0.25				Third Angle Projection	Drawing No.	REV	
	.XXX	~	±0.20				F/Name			
	Angle	~	± 3°							